

Kalay Home Smart Light Camera



Copyright

Copyright © 2017 ThroughTek Co., Ltd.

All images, text and data contained in this document are copyrighted. No part of this document may be reproduced, distributed, or transmitted in any form or by any means, including photocopying, recording, or other electronic or mechanical methods, without the prior written permission of ThroughTek Co., Ltd. (hereinafter referred to as "The Company"). The Company cannot and does not warrant the completeness, accuracy, merchantability, or fitness of the content herein, and the Company shall not be held liable for any damages, direct or indirect, punitive, incidental, special, consequential or other damages arising out of or in any way connected with the use of this document or its content.

Contact

Website: kalayhome.throughtek.com
Email: csd@tutk.com

02

Installation

1. Please remove the plastic cover from the device to unscrew and remove the back cover
2. Place the back cover against a wall, wooden piece or any solid material

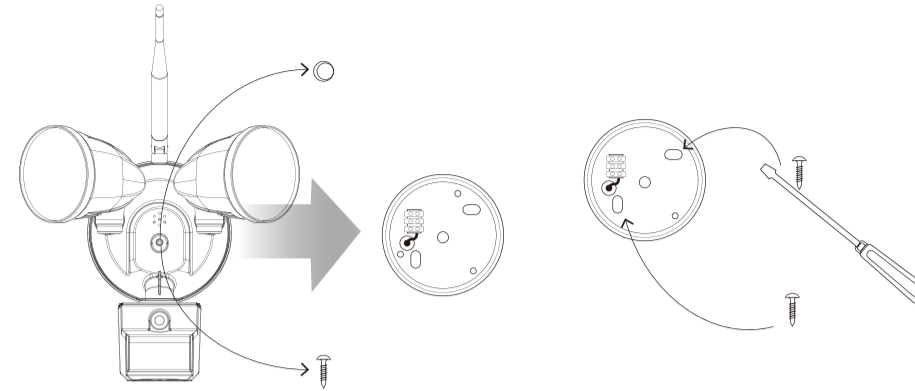

03

3. Use the screws to tightly secure the back cover
4. Connect the the AC power adapter into a power outlet

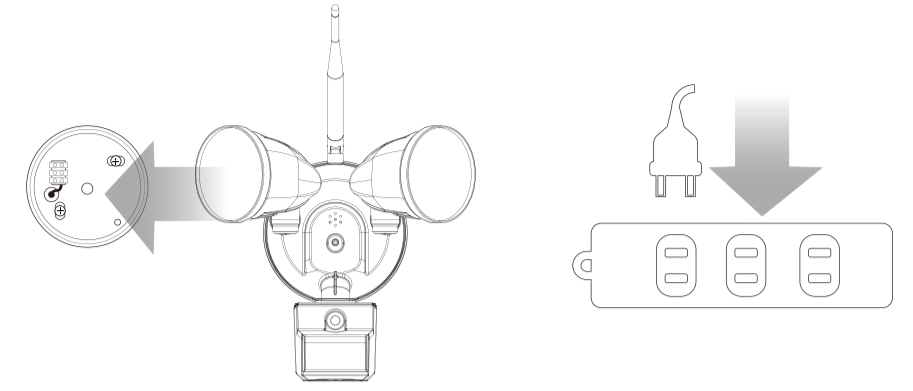

04

Product Parts

1. Wi-Fi Wireless Antenna
2. Light Case Adjustable Joint
3. LED light bulb
4. Camera Adjustable Joint
5. Camera Lens
6. PIR Sensor
7. SD Card
8. Speaker
9. Screw
10. Microphone
11. Restart Button

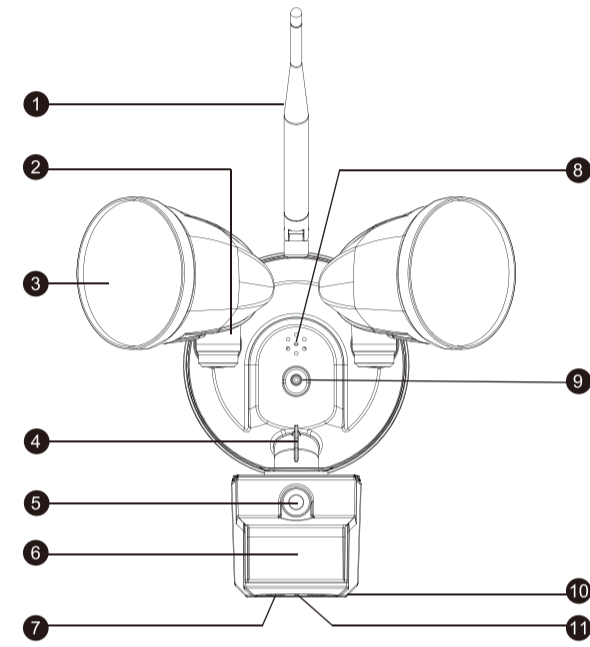

05

Technical Specs

General	
Weight	960 g ± 15 g
Power Supply	AC 110-240 V / 50-60 Hz
Power Consumption	24 W
Camera	
Image Sensor	1M, 1/4 inch CMOS sensor
Sensor Area	1/4 inch
Focal Length	2.0 mm
Field of View	120°
IR Proximity Range	12 m
Video	
Compression	MPEG / H.264
Imaging Color	Day / Night Color
Resolution	1280 x 720
Frame Rate	5-25 fps
System Integration	
Storage	Supports up to 32 GB Micro SD Card
Alarm and Event	Motion detection and real-time notification / event recording
Wireless Connection	802.11 b/g/n

06

App Download

Search for "KalayLightCam" on Google Play or App Store and download it to your mobile device.



Or scan the below QR Code to download the app:



Android



iOS

Compatible Mobile Operating Systems:
For iPhone: iOS 9 or above
For Android: Android 4.4 or above

07

Add Device on Android / iOS

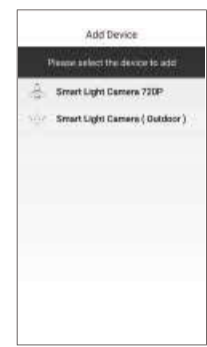

1. To add the device, open the KalayLightCam app and tap **+** button.

2. Select "Smart Light Camera - Outdoor"

08

Add Device on Android / iOS



3. Tap to select the appropriate LED Indicator Light status you see on the device.

LED Indicator Light - Wi-Fi Status:

Flashing Blue Light: Device in AP mode and is not connected the internet (go to step 3.1)
Solid Blue Light: Device connected to the internet (go to step 3.2)

09

Add Device on iOS

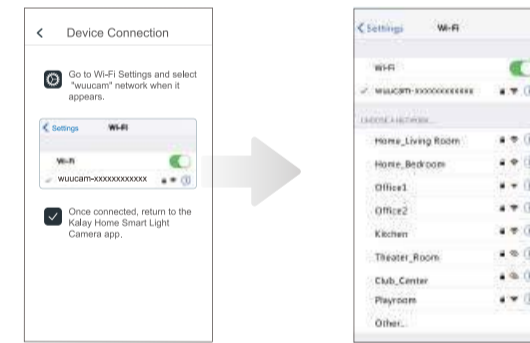

- 3.1 If your device is not connected to Wi-Fi, go to iPhone Settings then go to Wi-Fi and select "wuucam" to connect your mobile to the device.

Note: Device Wi-Fi: wuucam:***** / Password: 12345678

Once connected to the device, return to KalayLightCam app and follow on-screen instructions

10

Add Device on Android / iOS

- 3.2 If your device is already connected to Wi-Fi, follow the steps on screen to locate and setup a device.



- Option 1: Scan QR Code
Scan the QR code located at the base of the device, App "Share this Device" or the QR Code tag



- Option 2: LAN Search
Select the Device UID that is associated with your device, which is attached on a card tag with the device

Note: To add the device to your mobile, please make sure you are connected to the same Wi-Fi network as the device.

11

Add Device on Android / iOS

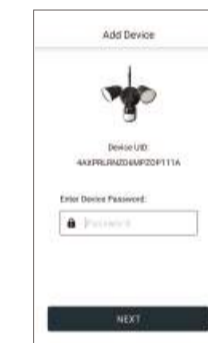

4. When the device has been detected, enter the password, and tap "Next" to proceed.

Note: The default password for an out-of-box device is 888888. If you forget your password, press and hold the reset button for about 8 seconds until the indicator light starts flashing red to restore factory settings.

12

Add Device on Android / iOS

Follow the next couple of steps on-screen if you are adding an out-of-box device or a device that has been reset.

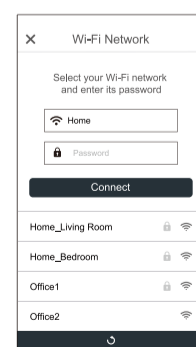

5. Setup Wi-Fi Network
A list of nearby Wi-Fi networks will appear. Select your Wi-Fi network from the list and enter the password.

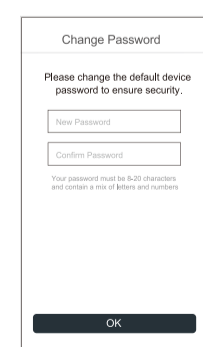

6. Update Device Password
Enter a new password to complete setup. For security reasons, it is recommended that you change your password regularly.

Note: To change the Wi-Fi network connected to the device, press and hold the reset button for approximately 3 seconds or until the indicator light starts flashing blue.

13

Add Device on Android / iOS



7. Name your device and tap "Go to device list" to return to the dashboard.



8. The dashboard screen will appear after setup has finished.

14

Live View

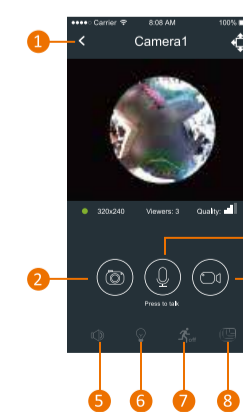

1. Go Back
2. Snapshot
3. Talk Function
4. Record Video
5. Mute Speaker
6. Smart Lighting
7. PIR Sensor
8. Video Quality

15

Settings



1. **Device UID:** A unique identifier (UID) is a numeric or alphanumeric string that is associated with a single device.
2. **Share the Device:** Use the QR code method to share a device
3. **Device Name:** Modify the name of your device.
4. **Device Password:** Displays the current password and allows you to input the password to connect to the device.
5. **Change Password:** Modify your device password. It is recommended that you change your password regularly.
Note: If you forget your password, reset the device by restoring to factory settings.
6. **Wi-Fi Network:** Displays the Wi-Fi network you are connected to.
7. **SD Card:** Format or clear data from your SD card.
8. **Firmware Version:** Displays your current version and any new updates.
9. **Remove this device:** This will delete the device from app

16