



Start Up Screen

Main Page

## 6.1 Quick NVR Setup using Kalay Cam

1. In MAIN PAGE, 2 modes – LIVE and CAMERA – are available. Default is LIVE mode
2. Click [CAMERA] to Camera mode screen
3. Then click [+] sign to add NVR. Maximum allow user to add 4 NVRs.
4. Scan QR-code containing UUID
5. Enter the password. User may also change the name of the NVR for easy identification.

Note: Default password is "888888"; Default name is "Camera"

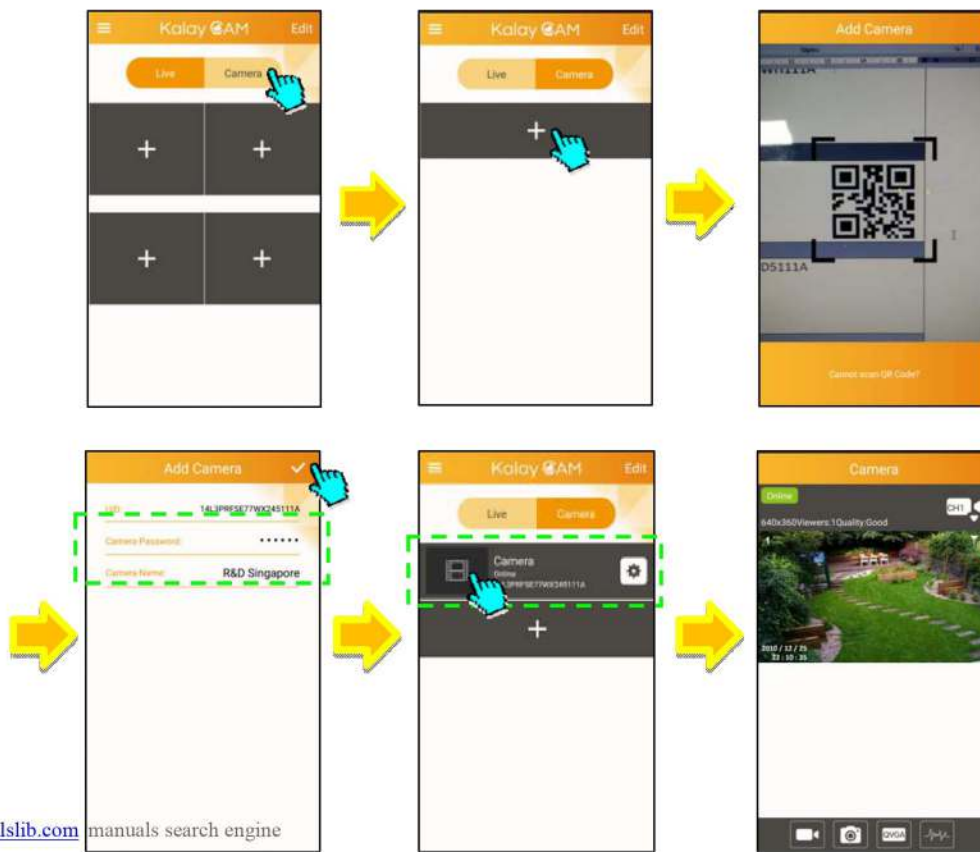

6. Wait the APP search for camera and adds to the device list
  7. Click the LEFT-side of added camera to start Live View.
- Note: Camera #1 of NVR is displayed by default
8. Rotate smartphone 90 to view in landscape mode (Full Screen)
  9. Zoom & Pan
- In both portrait & landscape mode, user can zoom and pan video

### Zoom

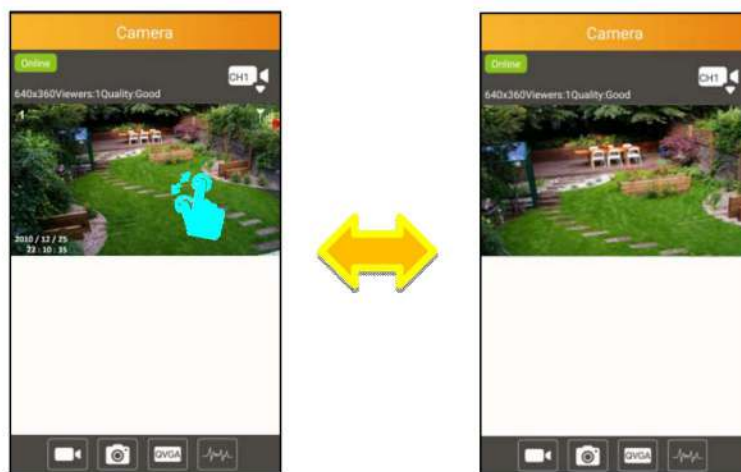

Use 2-points finger slide motion to zoom in/out video screen

### Pan

After zoom in, swipe on the display to pan the video















## 6.2 More functions in CAMERA mode



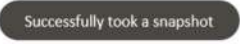

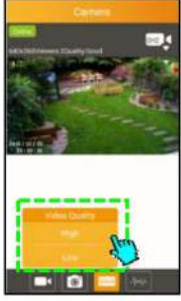
In Landscape mode, CLICK screen once for the MENU bar

	<p><b>Channel Select</b></p> <ul style="list-style-type: none"> <li>• By default, camera #1 is displayed when NVR is added</li> <li>• User can view another channel of the NVR <ul style="list-style-type: none"> <li>○ Click [Channel Select] icon to get the channel drop list</li> <li>○ Click the desired channel to change the Live View channel display</li> </ul> </li> </ul>	
 	<p><b>Video Record</b></p> <ul style="list-style-type: none"> <li>• Click  to START; or click  to STOP video recording</li> <li>• Record duration is shown on screen </li> <li>• Video are stored locally in smartphone's memory storage with directory named as "/Record"</li> </ul>	
	<p><b>Snapshot</b></p> <ul style="list-style-type: none"> <li>• Click to take a snapshot</li> <li>• Toast message box indicates snapshot taken OK </li> <li>• Photos are stored locally in smartphone's memory storage with directory named as "/Snapshot"</li> </ul>	
	<p><b>Video Quality</b></p> <ul style="list-style-type: none"> <li>• Click to select video quality</li> <li>• Select [HIGH] for 1280x720; or Select [LOW] for 640x360</li> </ul>	



**Environmental Frequency**

- Click to change environmental frequency according to local standard – 50Hz or 60Hz



### 6.3 LIVE mode setting

- Kalay Cam starts at LIVE mode by default
- In CAMERA mode device list, click [LIVE] tag goes back to LIVE mode  
In LIVE mode screen, camera windows are arranged in pages. Each time when 4 windows in 1 page are all occupied, new page is automatically created, swipe LEFT/RIGHT to see windows in other pages.

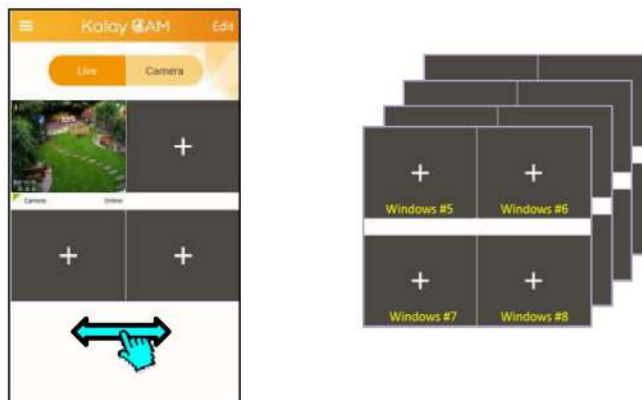

#### Add NVR to LIVE mode window

- Each time user adds a new NVR, Kalay Cam automatically adds the camera to the first available window. For example, in above image, windows #2 is empty, when user adds a new NVR, it will be added to windows #2.
- Manually adds a NVR's camera
  - Click on an empty window for the Camera List (NVR List)
  - Click the camera icon (Top Right corner) and select one of the 4 camera of the NVR
  - Click OK to add the camera to the window

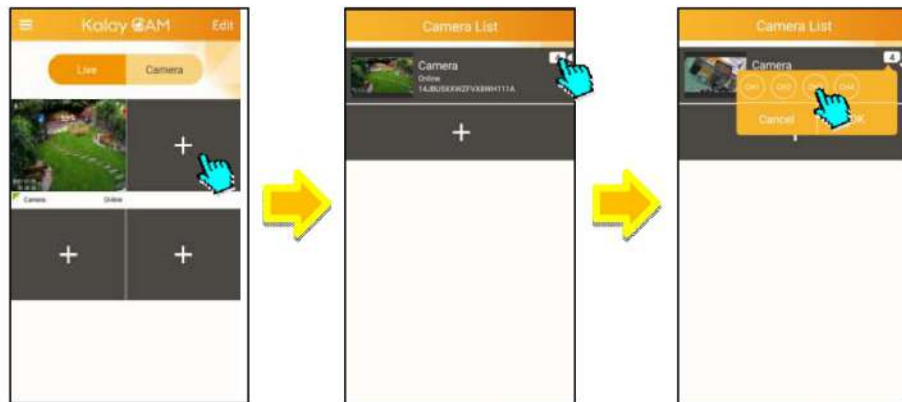

### **Remove NVR from APP**

1. In LIVE or CAMERA mode, click [EDIT] at TOP-RIGHT corner
2. Select one of the window or camera
3. Click the recycle bin icon
4. Click [OK] to remove

#### **Live Mode**



#### **Camera Mode**





### **Other Window Menu Functions**

Click the MENU icon (Top Right corner) of each camera windows for the Camera Window Menu



#### **Change Camera**

- Click for the Camera List (NVR list)
- Click on the Camera icon (Top right corner) of the desired NVR
- Select desired camera channel, then click [OK] to change

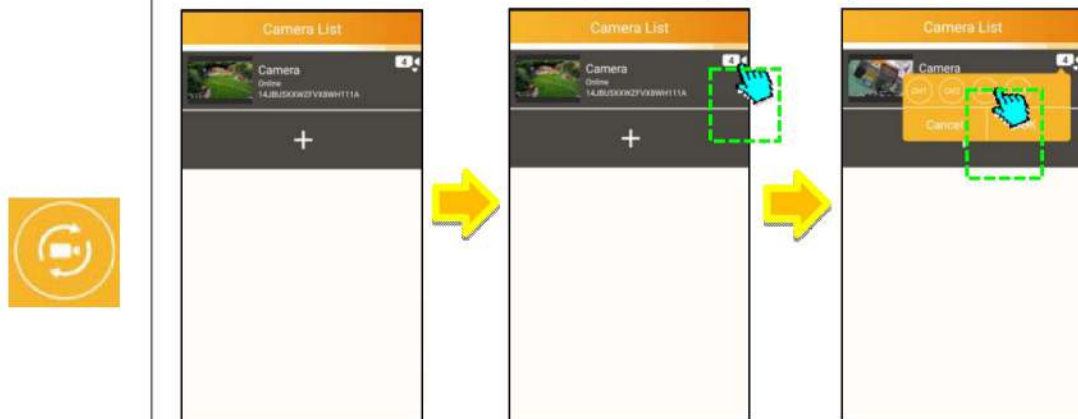

Note: User may assign the current window

- To another camera of the same NVR; OR
- To a camera of another NVR

## Event List

- Click to browse list of video file stored in NVR HDD of the selected camera channel

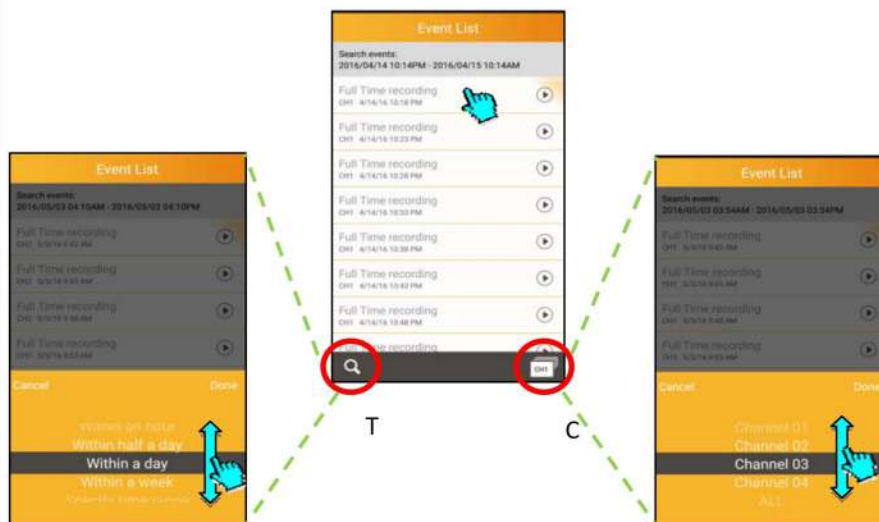

User may also click on the search option icons (bottom bar), 2 video files search option are available, slide up or down to select:

### (1) Time search





File list is filtered for time period

- Within an hour
- Within a day
- Within a week
- User specified time frame

### (2) Channel search

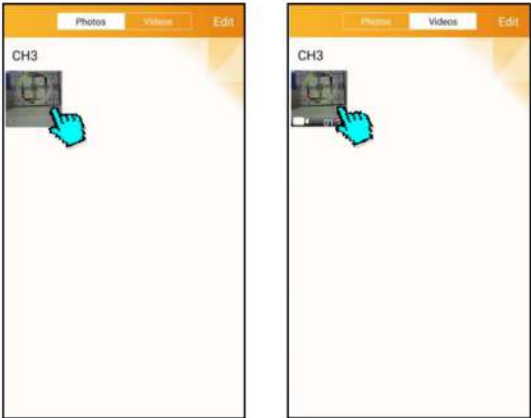
File list is filtered per camera channel basis

- Channel 1
- Channel 2
- Channel 3
- Channel 4
- ALL channels

	<p><b>Local Media File</b></p> <ul style="list-style-type: none"> <li>Browse media files (photos &amp; videos) stored in smartphone             <ul style="list-style-type: none"> <li>Photos – stored in “/Snapshot” directory</li> <li>Video – stored in “/Record” directory</li> </ul> </li> </ul> <p>Simply click thumbnails to view photos or video clips. Video clips can be played back both in landscape &amp; portrait mode.</p> <div data-bbox="636 506 1164 921">  </div>
	<p><b>Camera Settings</b> Review NVR information and various options</p> <p>i. Camera information – UID, camera name &amp; password(hidden)</p> <div data-bbox="498 1184 846 1352">  </div> <p>ii. Change password</p> <ol style="list-style-type: none"> <li>Simply enter Old password, New password, New password again</li> <li>Click [OK] to confirm changes</li> </ol> <div data-bbox="498 1549 854 1761">  </div> <p>iii. Notification Interval</p>



Turn notification ON or OFF



#### iv. Recording Mode

Select Recording Mode

- i. Off – no recording
- ii. Full Time – Always record
- iii. Alarm – Record after motion trigger



#### v. Event Settings

Turns Motion Detection On or Off

Set Motion Detection sensitivity – LOW, MEDIUM, HIGH, MAX

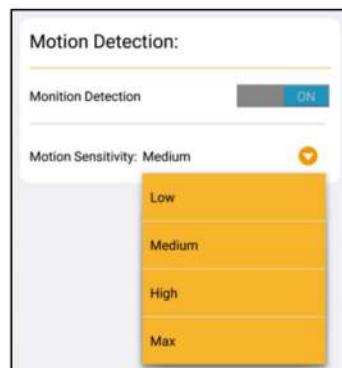

#### vi. Camera Information



Click to display NVR information

<div> <div>Camera Information</div> <div> <div>Model: SN93566</div> <div>Version: 16.4.21.1</div> <div>Total Space: 952416 MB</div> <div>Free Space: 662310 MB</div> </div> </div>	<p>Model – Main Chipset information</p> <p>Version – Firmware version</p> <p>Total Space – HDD total available capacity</p> <p>Free Space – HDD remaining capacity</p>	
	<p>vii. Reconnect</p> <p>Display NVR online status – ONLINE or OFFLINE</p> <p>If OFFLINE, just click to reconnect again</p> <div> <div>Reconnect</div> <div>Online</div> </div>	
	<p>viii. Remove this camera</p> <p>Delete NVR registration in the APP</p> <p>Click [Remove] and [OK] to confirm deletion of NVR</p> <div> <div>Do you want to remove camera(s)?</div> <div> <div>Cancel</div> <div>OK</div> </div> </div>	

### **Side-bar Menu**

Click side-bar menu icon at TOP-LEFT corner to activate the menu

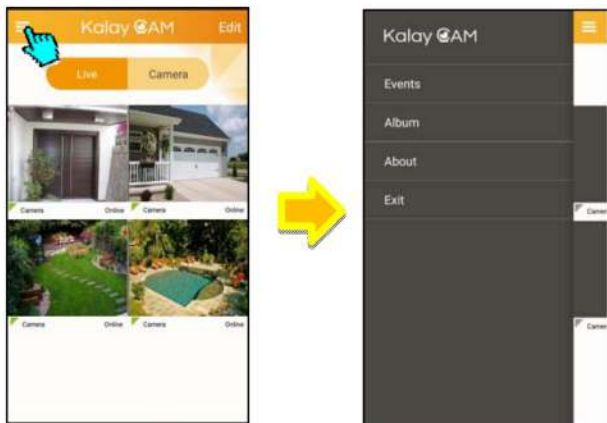

4 menu functions are available:

#### 1. Events

Browse and playback video file stored in NVR.

- a. Click and select NVR to browse video file list
- b. Click on filename to playback video clips

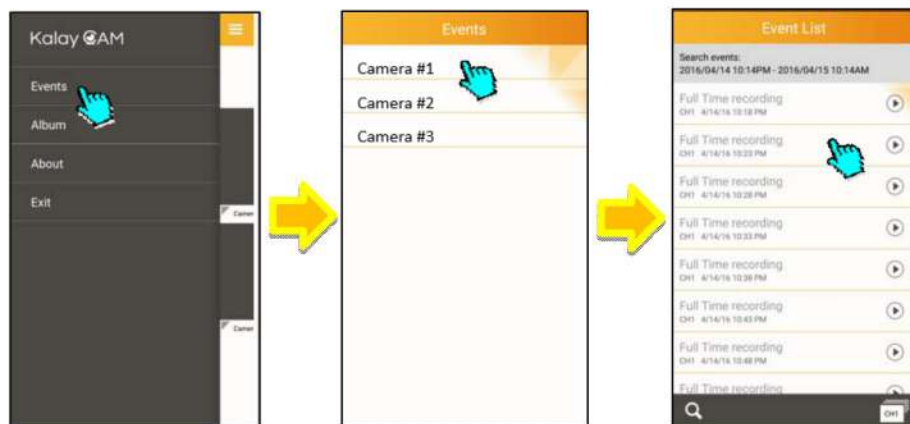

#### 2. Album

Browse media files (photos & videos) stored in smartphone

- a. Photos – stored in “/Snapshot” directory
- b. Video – stored in “/Record” directory

Simply click thumbnails to view photos or video clips. Video clips can be played back both in landscape & portrait mode.

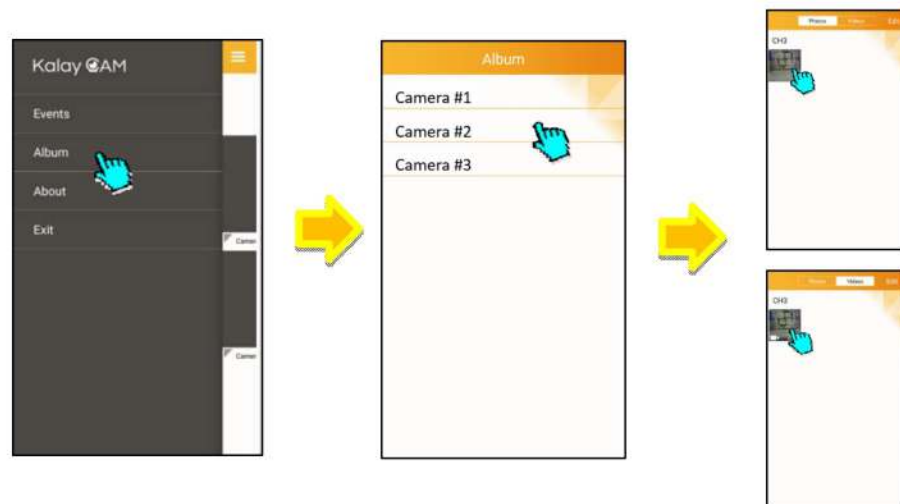

### 3. About

Display Kalay Cam version information



### 4. Exit

Click to close Kalay Cam.