



CONCEPT PRO LITE 3 APP GUIDE





CONCEPT PRO LITE 3 APP GUIDE

Download the Concept ProLite app on Apple or Android app stores

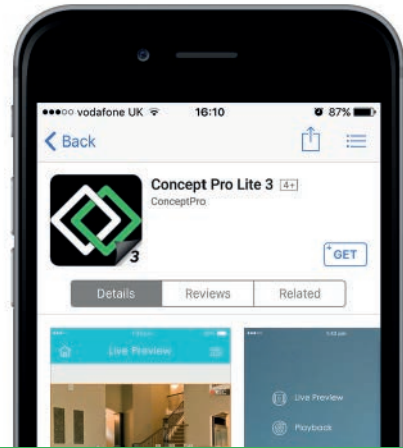

SETUP

- 1 Open the app and select the Home icon then 'Devices'

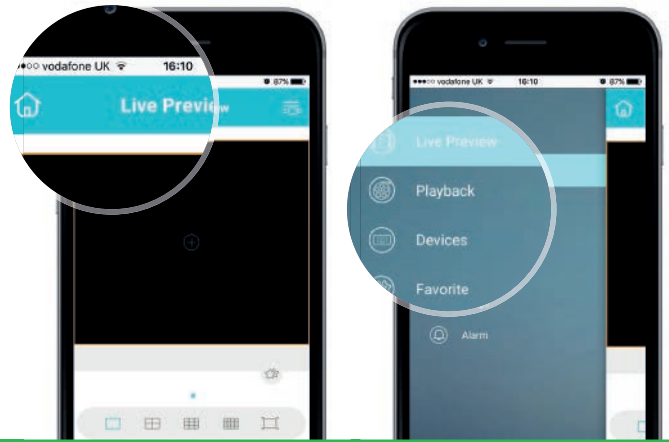

- 2 Select the '+' sign and add 'Cloud Devices'

- 3 Add Device Name and select 'NVR' in 'Device Type'.

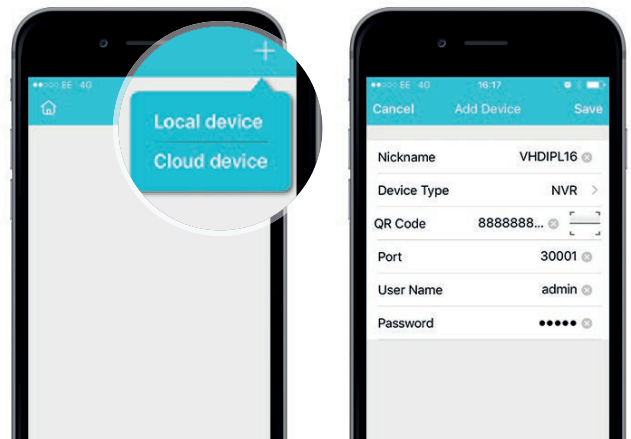

- 4 On the recorder, go to MENU  > Setting > Device Information and click the QR Icon  to display the unit's QR code on screen.





CONCEPT PRO LITE 3 APP GUIDE

- 5 Scan QR code & enter '30001' in 'Port'.
- 6 Enter 'admin' (lower case) into the 'User Name' and 'Password' (Only if default login information has been left unchanged).
- 7 Select 'Save' once complete

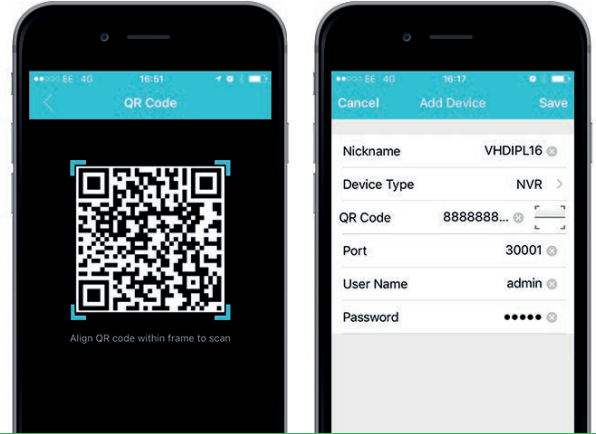

LIVE VIEWING

Main Functions

- Quad View
- View Single Camera
- Pause Selected Channel
- Take Snapshot
- Record Live Video Straight to Device
- Favourite Channel
- Pause All Channels
- View Full Screen/Landscape
- Adjust Video Quality
- PTZ Controls
- Remote Alarm Output Trigger

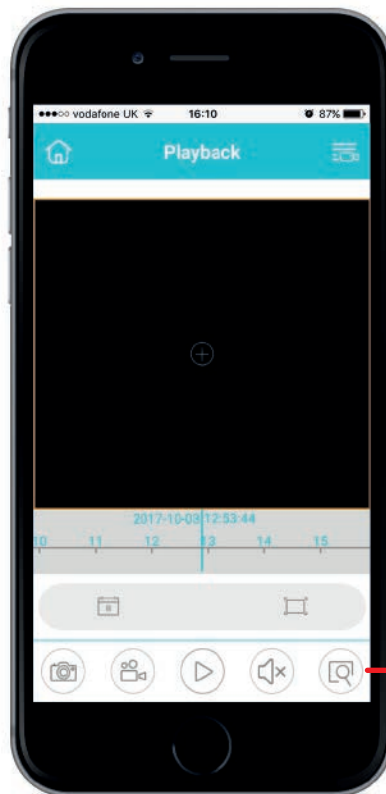

All the listed features are selected from the interactive icon scroll bar beneath the main view.

TAKE LIVE SNAPSHOTS & FOOTAGE

Tap the Snapshot button '

Video Record '

- To view your snapshots and footage select the Home icon then 'Images'.
- Your images will be listed with the most recent first.

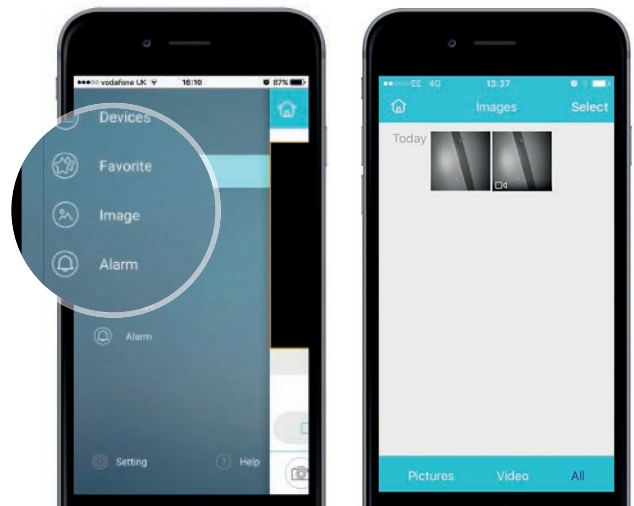



CONCEPT PRO LITE 3 APP GUIDE

VIDEO SEARCHING

Through the Concept Pro Lite 3 app, users can search through recorded footage from connected VHD IPL-V3 systems. To access footage, click the home icon and select 'Playback'. Then tap device list in top right hand corner to choose a camera from the list.

You can tap the calendar icon to search by date and then use the timeline to scroll through the day's footage. Tap the Snapshot button to take a live picture from a selected camera's recorded footage to save to a mobile device.

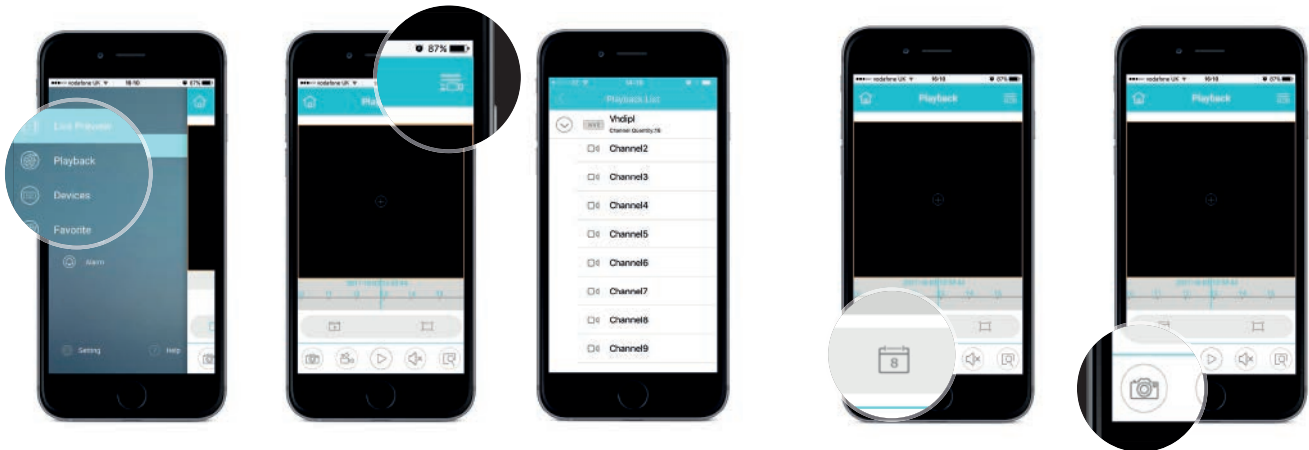

REMOTE ALARM

Remote Alarm Output Configuration Guide

- 1 Open the connection of NVR with properly configured alarm output.
- 2 Use the interactive scroll icon bar to locate the I/O alarm output trigger button.
- 3 Then select one of the alarm output triggers of the connected NVR alarm output.

Note

- a) When the alarm output is triggered this must be turned off from the NVR or Web browser interface.
- b) The alarm output trigger is for turning the alarm output 'ON', ideally to be used in emergency situations.

