

Manual for P2P IP CAMERA Android APP



Note : Make sure that the phone is able to connect to the Internet before use the Android APP..

• Download ways:

- Find the "CoolcamOP 6.0.apk" file in the CD. Install it at Android mobile phones. Please be patient until the Android APP is installed and displayed on the screen.
- Google users can shop, pea pods, 91 Assistant downloads, search the keyword "COOLCAMOP", find the P2PCAMOP software to install.

1. Initial interface

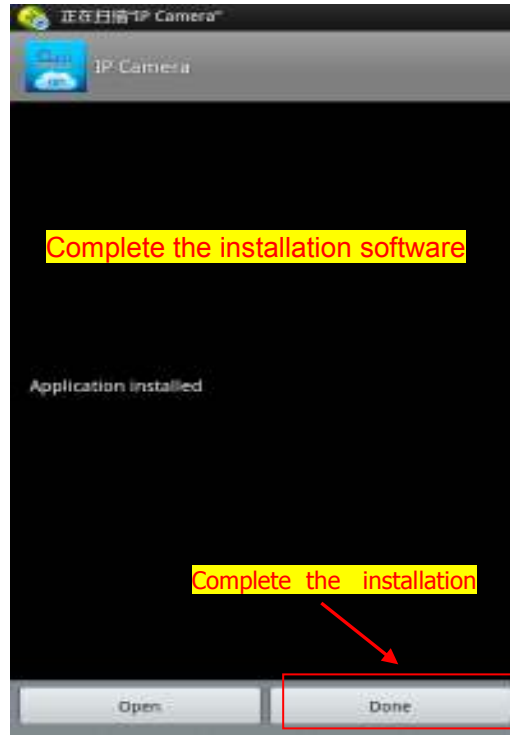
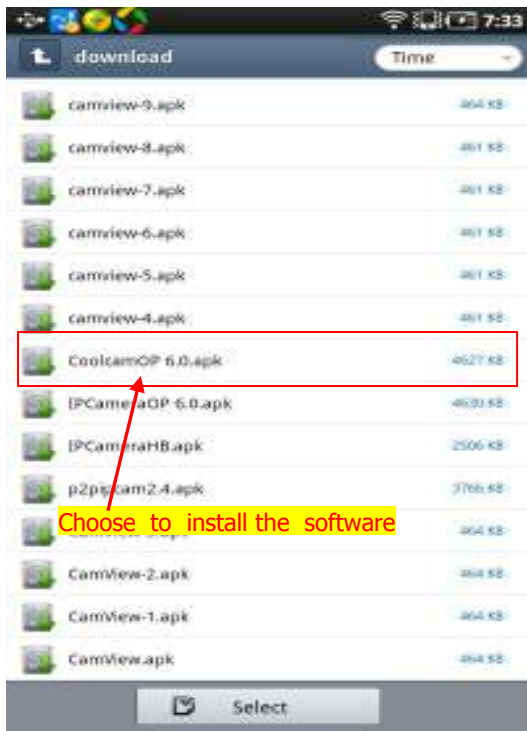

2. Add cameras

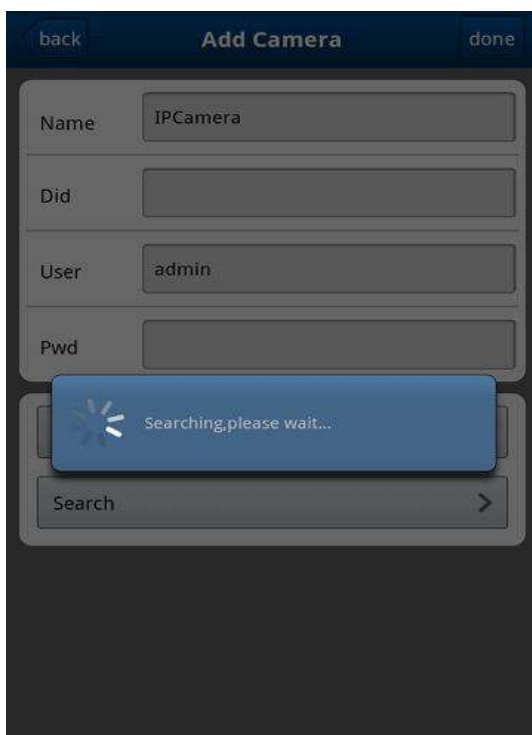
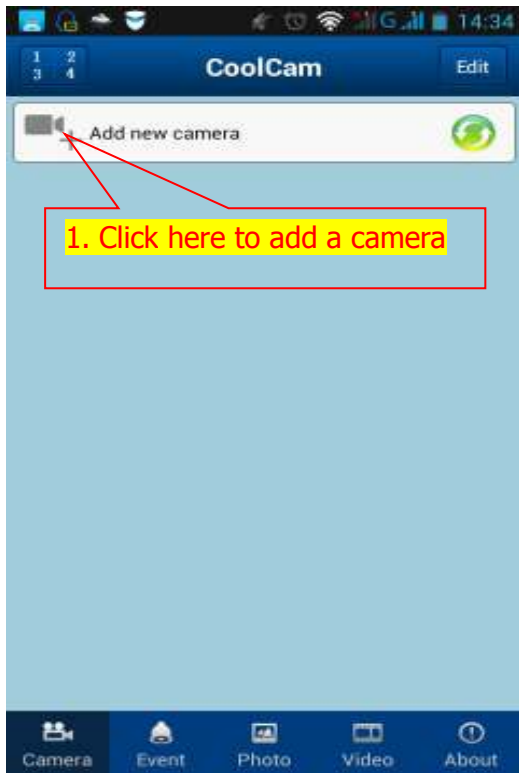

How to add cameras,pls check as below.

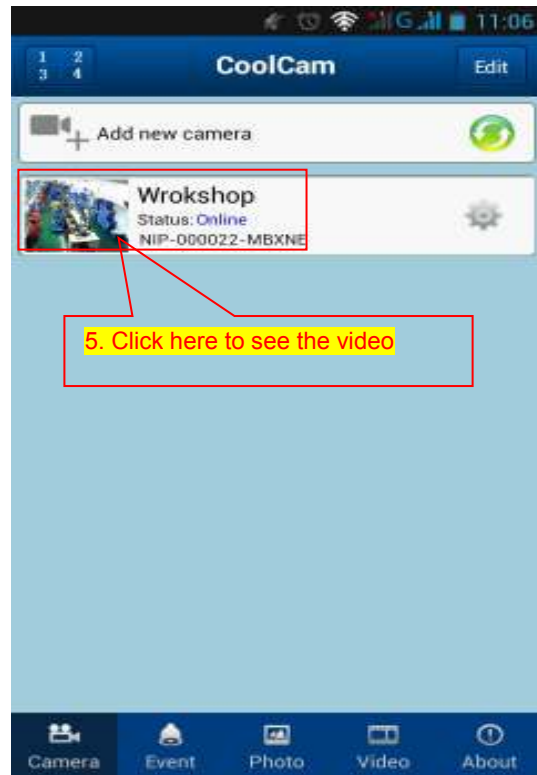
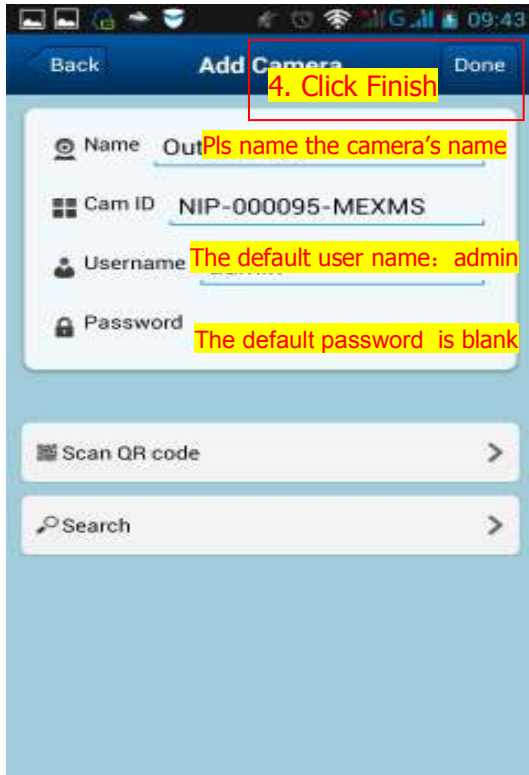



Three ways to add cameras.

One: Click Search LAN, user can search and add cameras in one LAN,if the cameras and phones are not in one LAN,then cameras won't be searched.

Two: Click " Scan ID"  Scan the QR Code on the housing of IP camera.  It will find and add the ID automatically,Then click to finish.

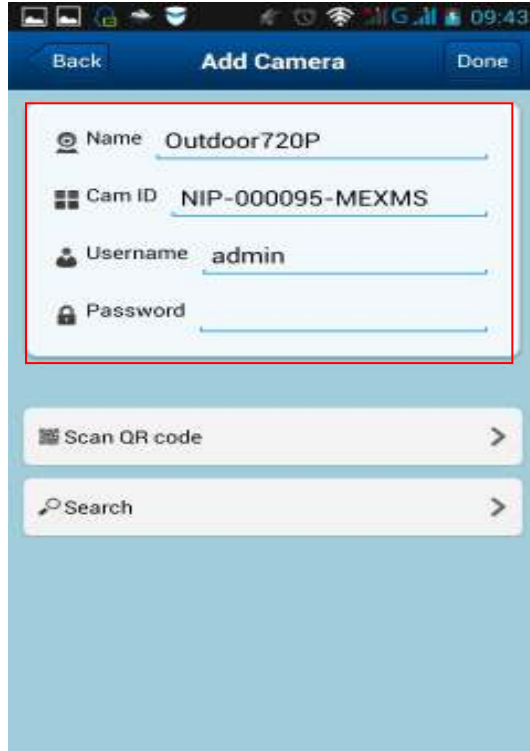

Three: Input the UID on the "Device ID" of the Android APP. The default username is: admin.No password.Note:the "Device ID" is on the bottom of the ip cameras.

- Graphic settings

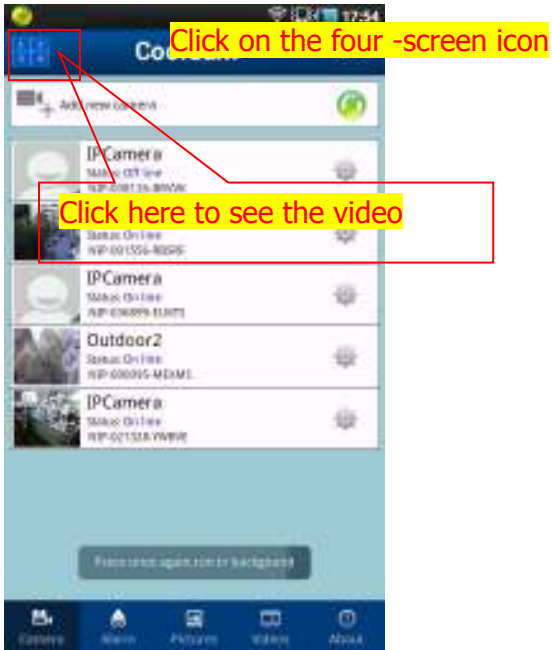

Four graphic settings, click on the list to the right of the camera

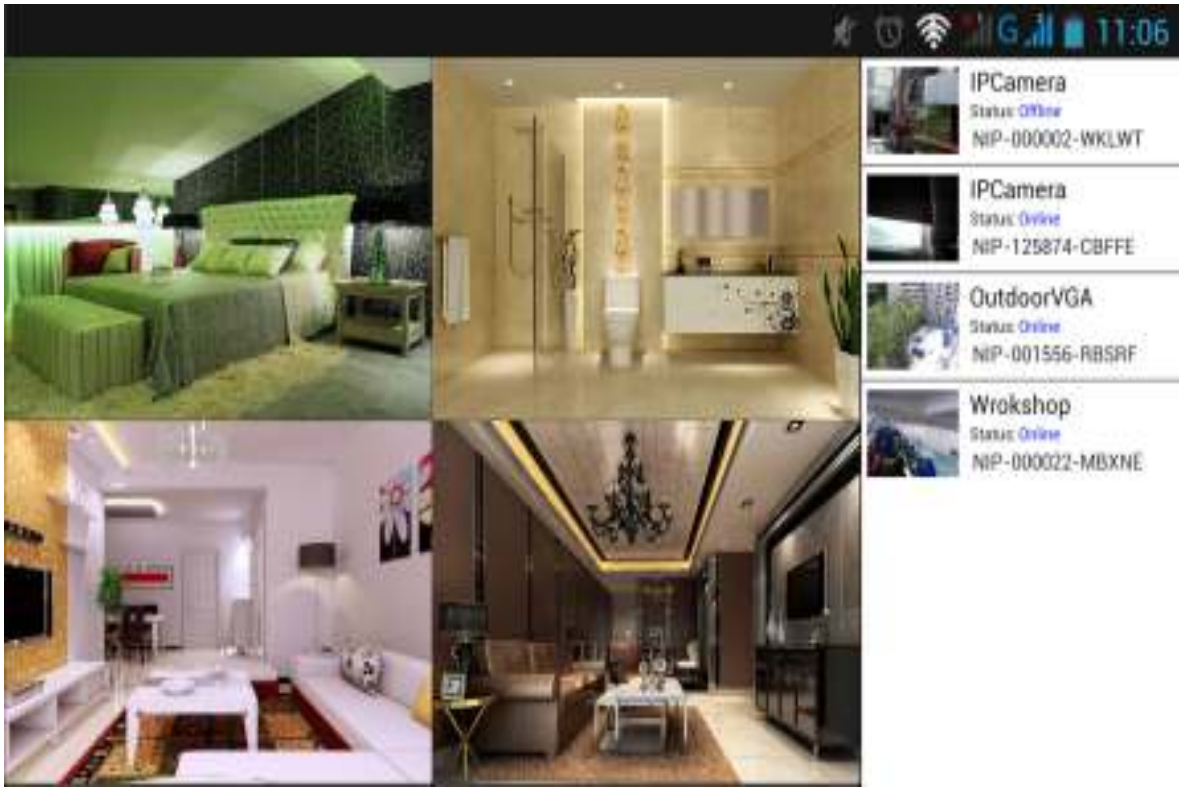

3. Viewing interface



Click Back to exit monitoring interface

Click on the menu operation interface

- The camera interface:



● Camera full screen mode::

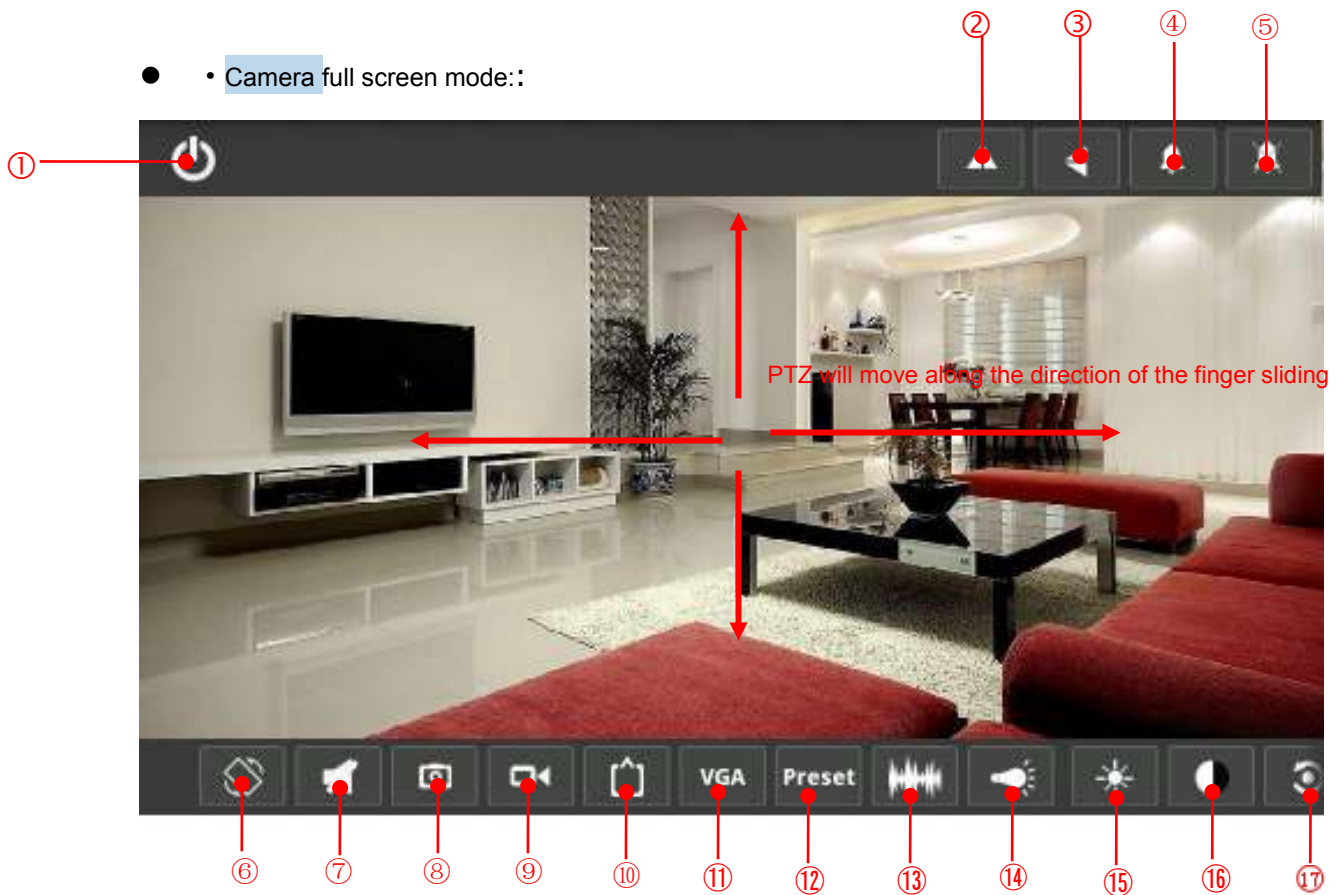

- | | | |
|---------------------|---------------------------------|-------------------------|
| 1. Exit video views | 2. About image flip | 3. Image upside down |
| 4. Police closed | 5. Report to the police to open | 6. On / off full screen |

- 7. On / off voice monitoring
- 8. Photo
- 9. Videos
- 10. Watch mode
- 11. Resolution switching
- 12. preset bit set
- 13. Power frequency setting
- 14. infrared light switch
- 15. Saturation
- 16. Contrast
- 17. Video parameters reset

4. The interface button function Description

Edit camera:

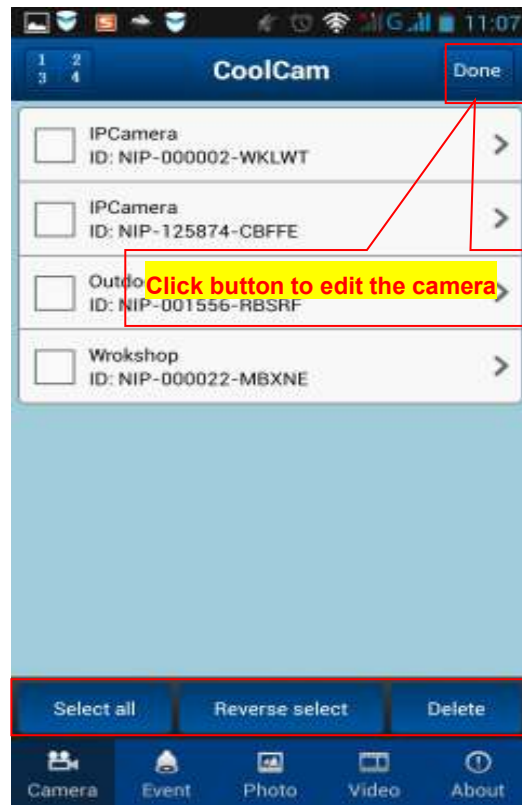
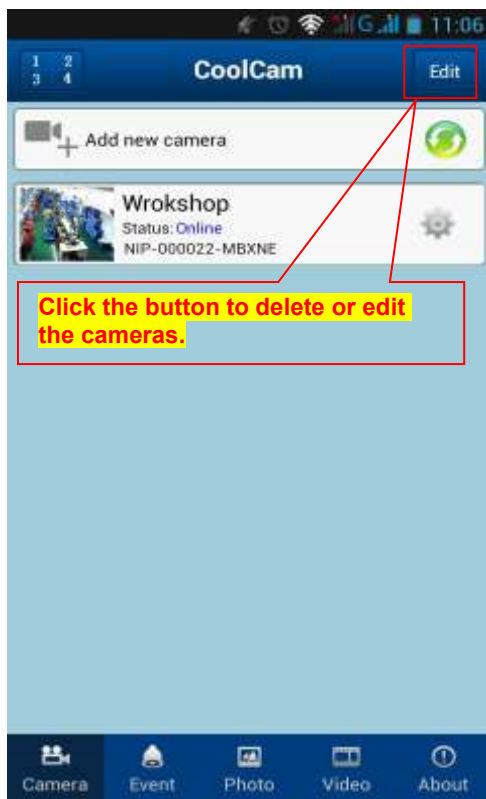

Alarm events, camera pictures and videos:

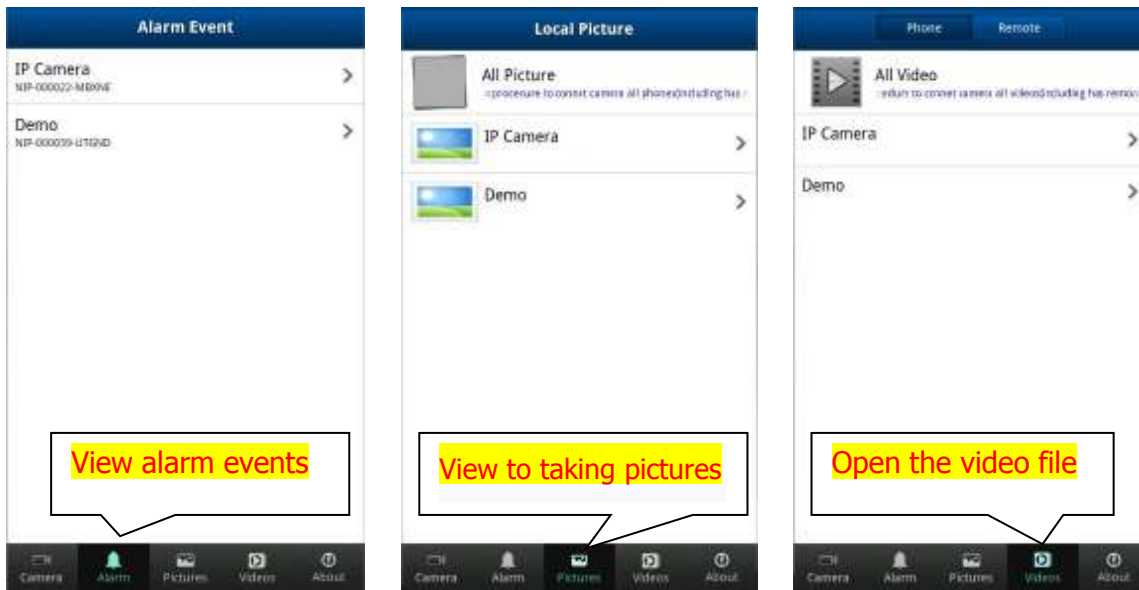

5.Remote video view

In video view inside "cell phone", "remote" video viewing, click on the remote to view the [video](#)

Supporting players such as: storm video

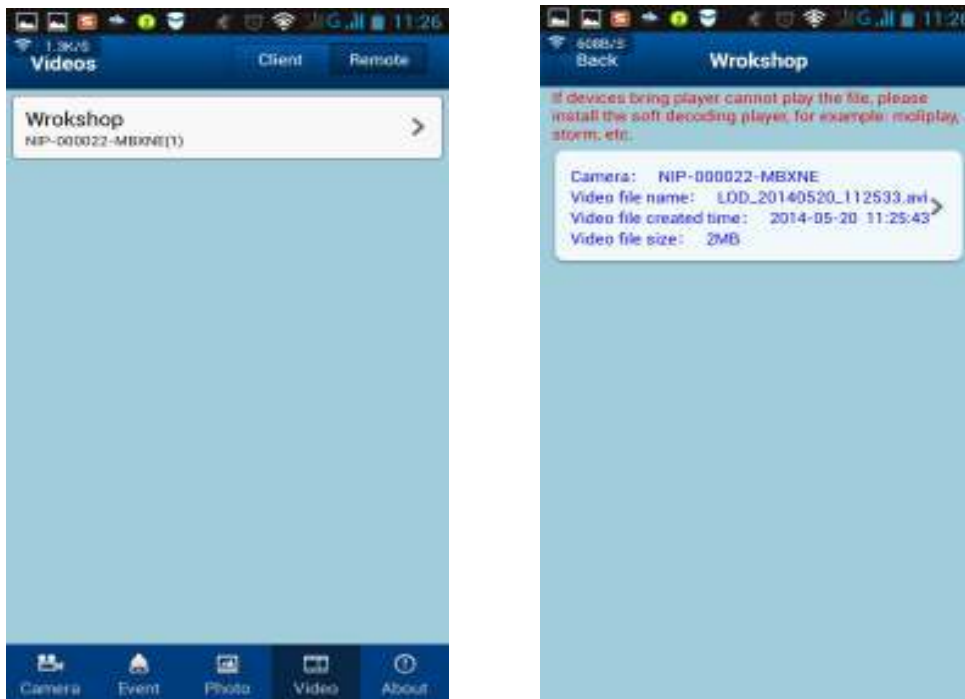

Camera settings

The circular arrows corresponding to the right of the selected equipment
Click equipment , to enter the camera settings interface , as shown below:

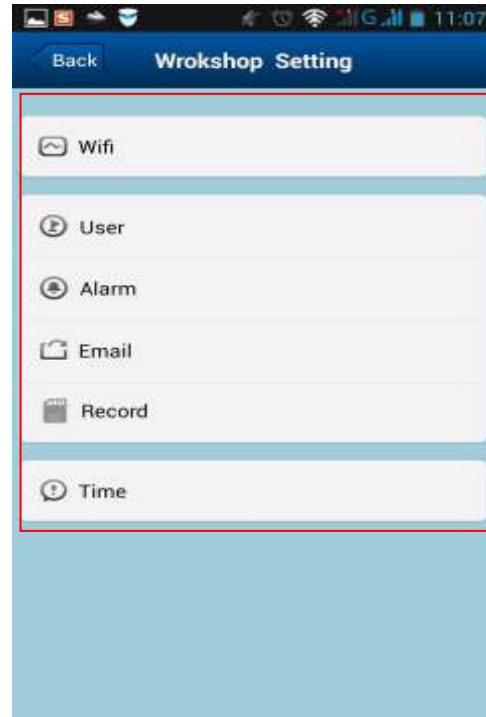
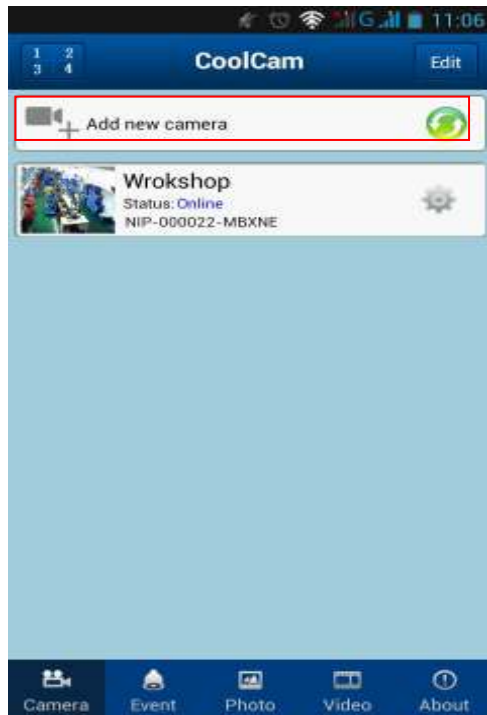

5.1 . **WiFi Setting** : click WIFI settings enter WIFI setting interface , the search near WIFI hotspot , choose a wireless router to enter the password , click OK , reboot your machine connected to WIFI , as shown below

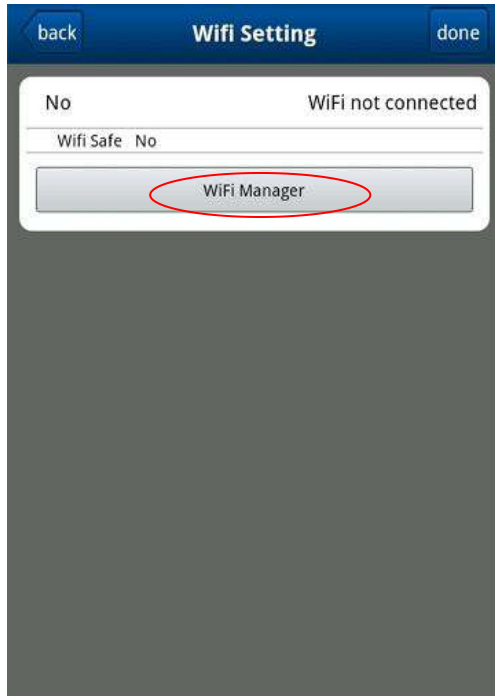

5.2 . **User Settings:** Can set user name and password of the administrator and operator

back **User Setting** done

Administrator

User:

Pwd:

Show Password

Operator

User:

Pwd:

Show Password

5.3 . Alarm settings: You can set the alarm parameters

back **Alarm Setting** done

Motion Detect Armed

Motion Detect Sensibility

Alarm Input Armed

Alarm trigger event

Alarm preset linkage No

IO Linkage on Alarm

Alarmed Mail Notification

Alarmed Record

Upload Image on Alarm

5.4 Mail Settings: You must fill in the correct sender and receiver mailbox and mail server parameters

back Mail Setting done

Sender Demo@sina.com

SMTP Server smtp.sina.com

SMTP Port 0

Need Check

SSL NONE

SMTP User Demo

SMTP Password *****

Receiver1 test@163.com

Receiver2 test@yahoo.cn

Receiver3 test@gmail.com

Receiver4

CE FCC

RoHS



IPHONE IPAD APP USER MANUAL



Note : Make sure that the phone is able to connect to the Internet before use the IPHONE,IPAD APP.

Download way.

To search and install the "COOLCAMOP" in the app store.

Pls check as below.



1. Search keywords "COOLCAMOP"



2. Find p2pipcam

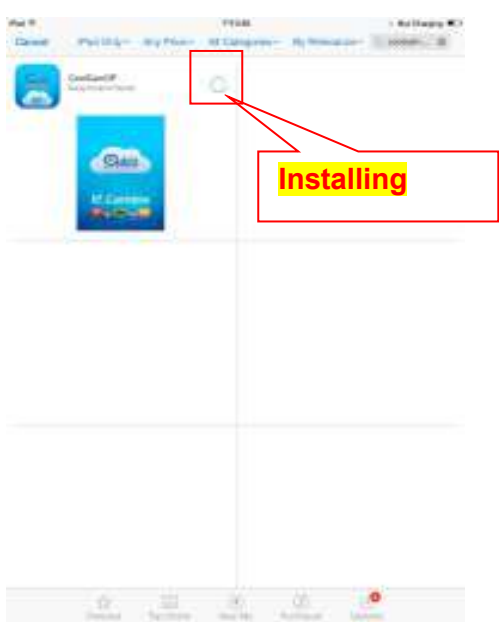

1. Initial interface

In the main menu of the phone, find the APP and run.

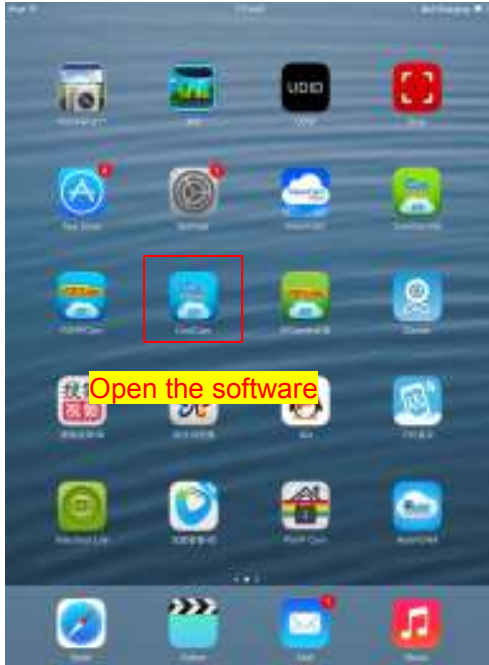

2. Add Device

There are some steps to finish the installation.

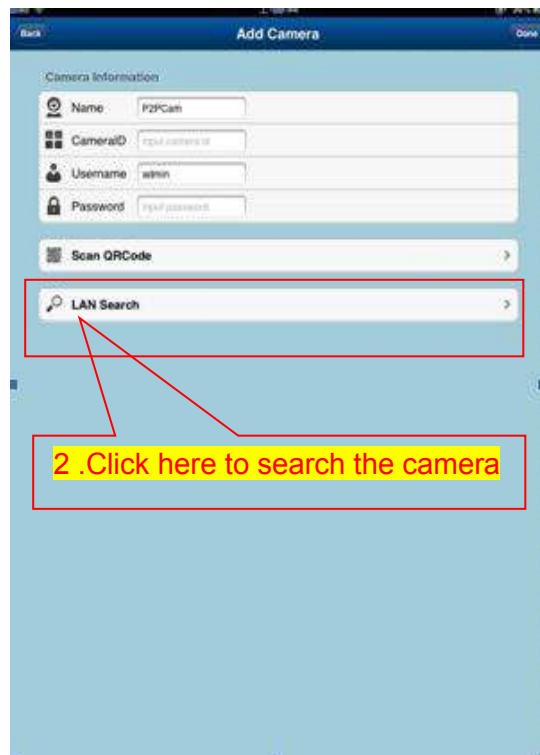

Way 2: Click " Scan QRCode"



Scan the QR Code on the housing of IP



camera. It will find and add the ID automatically, Then click to finish.

Way 3 : Input the UID on the "Device ID" of the APP. The default username is: admin.No password.Note:the "Device ID" is on the bottom of the ip cameras.

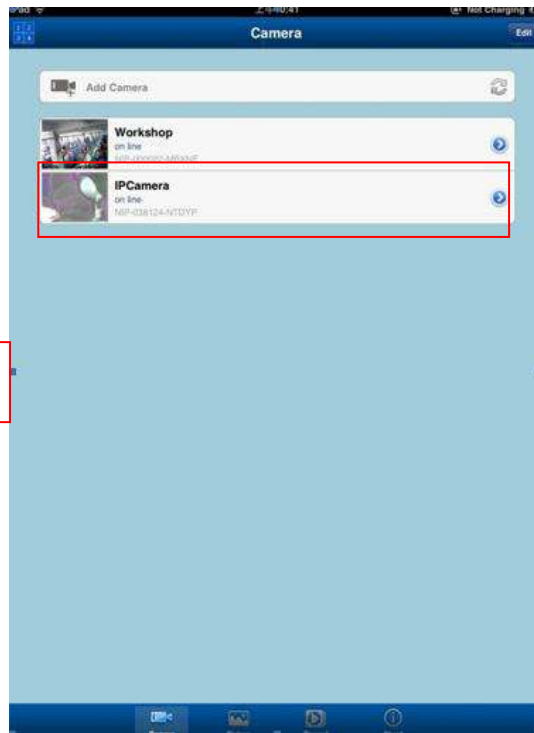
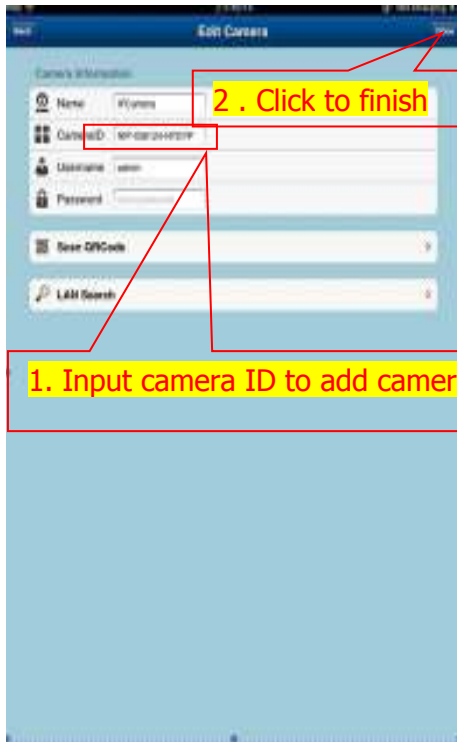

- Graphic setting



Four graphic settings, click on the list to the right of the camera



3.View interface



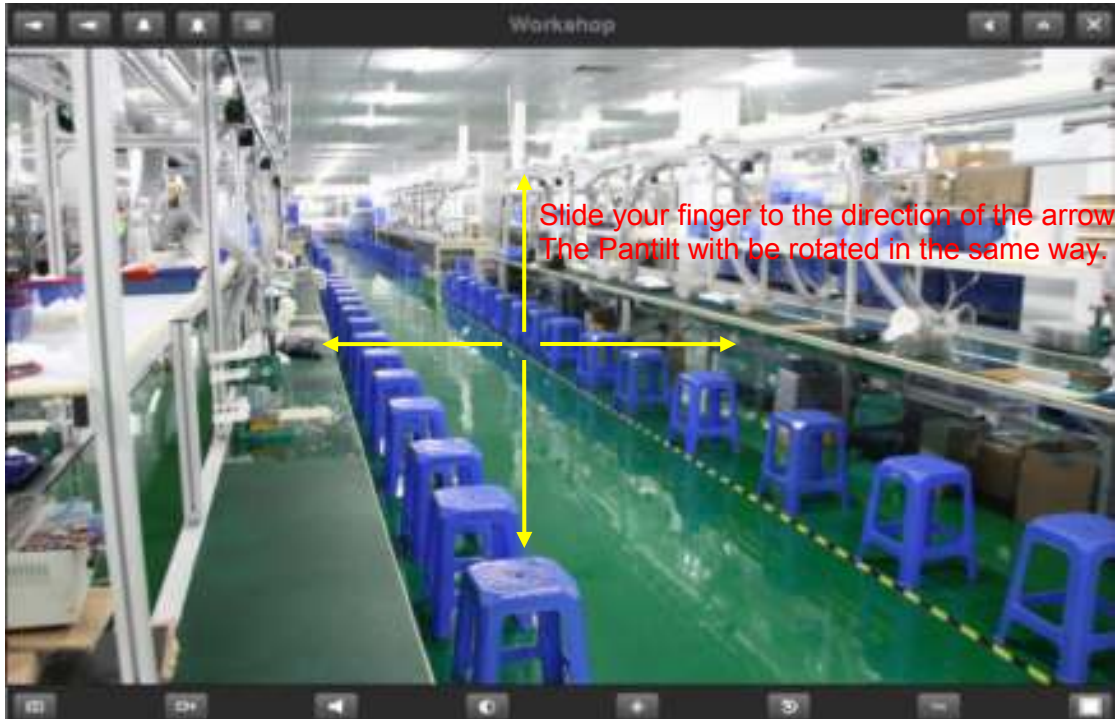

4. Function instruction of the interface button.

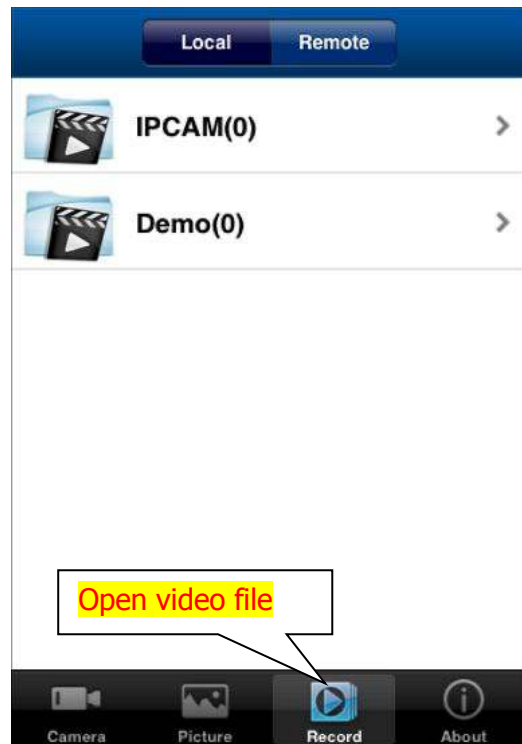
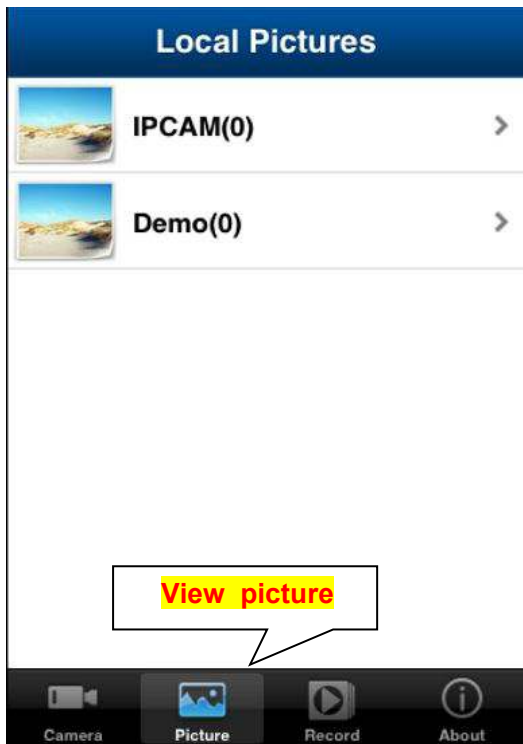



4.1 PTZ control:



Function description (from left to right):

1. Infrared lamp closed
2. Infrared lamp open
3. Police closed
4. Report to the police to open
5. Watch the setting
6. Screen upside down
7. Reversal left and right on the screen

4.2 Tool Menu:



Function description (from left to right) :

1. Photograph
2. Record

3. Audio / mute
4. Talkback
5. Contrast adjustment
6. Brightness adjustment
7. Video parameters to restore the default values
8. Resolution adjustment (When the mobile or IP camera in poor network, it can adjust resolution and reduce the quality.)
9. Full screen display / returns

5. Camera setting

The function setting: Select the IP camera ,click the rounded arrow on the right and enter the setting interface of the camera.Then operate as follows:

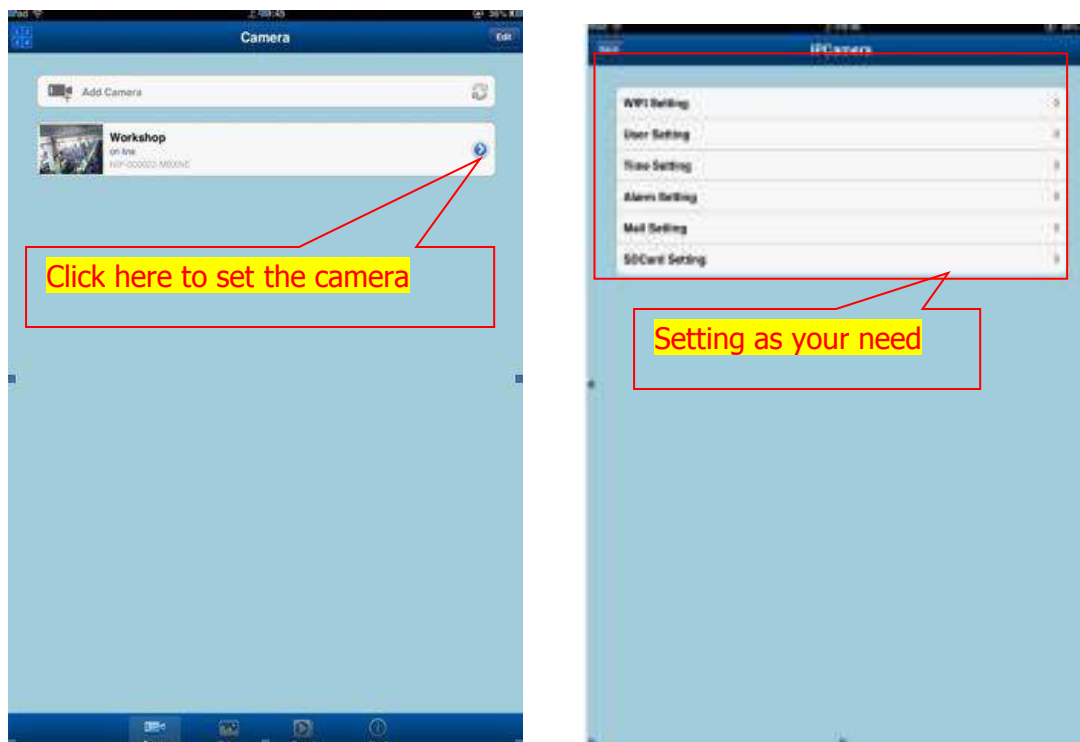

Parameter settings: Enter edit mode to modify parameters or delete the camera.

As following :

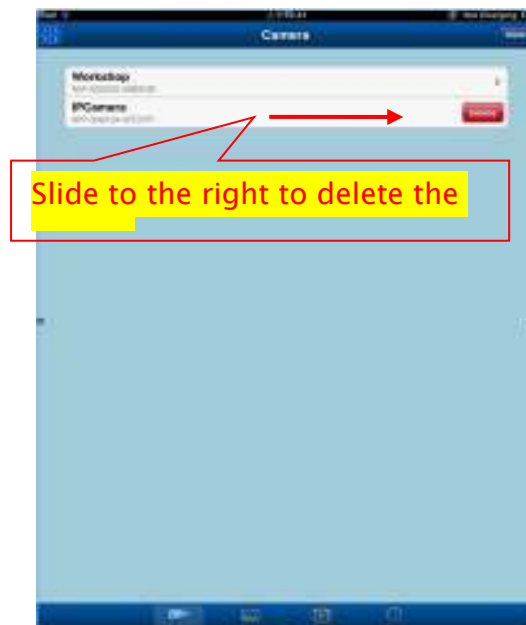
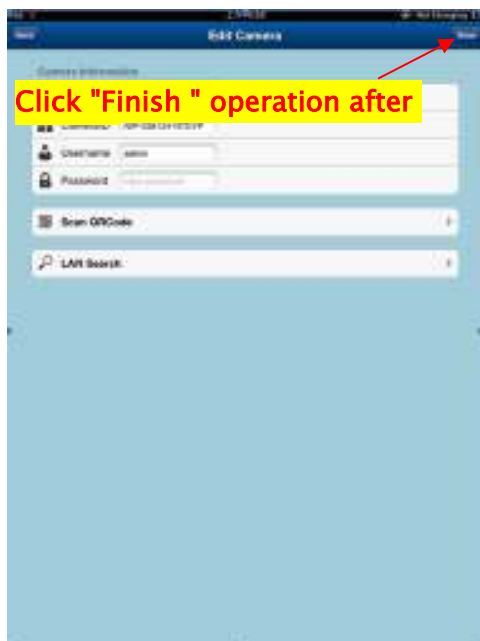
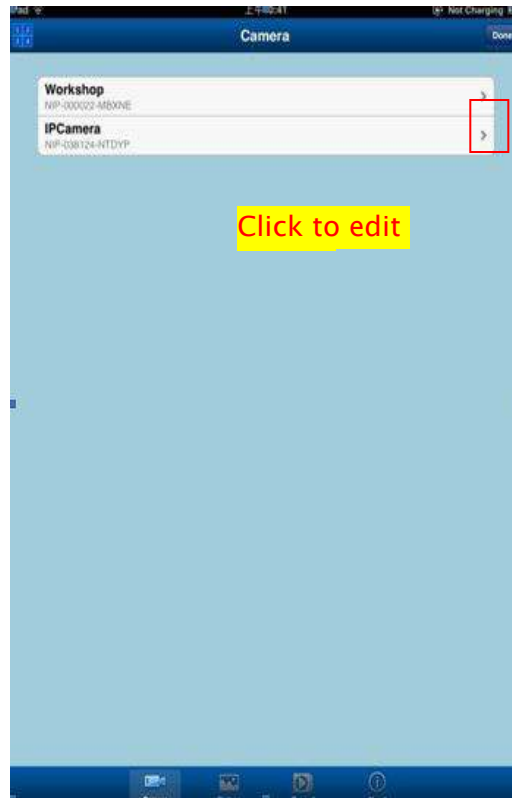

- User settings

Click on user settings, you can modify the user name and password, and users can also create visitors.



- WiFi settings

Click the **【wireless settings】** automatically search for nearby wireless device, select your **wireless** device, enter the wireless password, the machine will reboot after Setup is complete, unplug the network cable.



➤ **Wireless Setup successful** reboots the machine, unplug the network cable for wireless

- Alarm Setting

Click the "alarm set" open motion detection alarm, sensitivity as low as sensitive, open the mail notification, alarm SD card video



➤ Lower the sensitivity more sensitive to motion detection settings to check the mail notification

- Mail settings

Click on the "mail settings" and enter the email address of the sender, SMTP server, SMTP port 25 by default, open the inspection, enter sender's user name and password, fill in the recipient's address.



- Remote video view

Click on the "video"- "remote" can view remote video

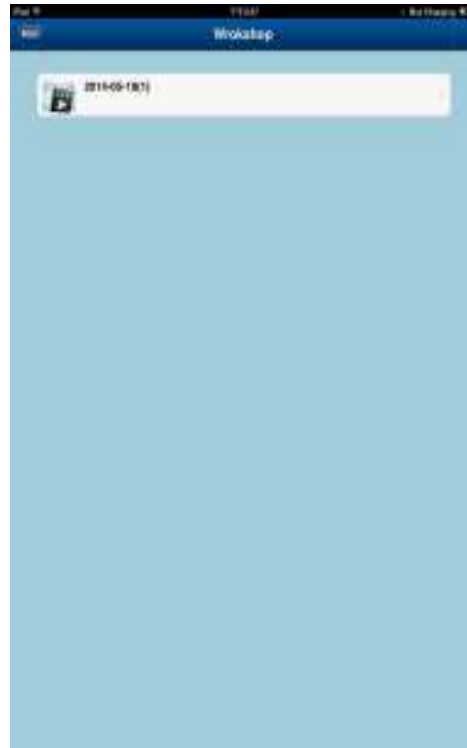

- View online videos



